

G SERIES SANITARY CLAMP (PRECISION TURBINE METERS)

The G Series High Precision Meter is the most accurate of all the FLOMEC® Turbine Meters:

FEATURES / BENEFITS

- Meter includes a traditional design
- Available in a variety of sizes

APPLICATIONS

- | | |
|--|----------------------------------|
| • Fuel | • Process Control |
| • Batching | • Chemical Feed Lines |
| • Food & Beverage | • Irrigation |
| • Petro Chemicals | • High Water Volume Mixing |
| • Pharmaceuticals | • High Precision / High Pressure |
| • Thin Viscosity Fluids Under 100 Centipoise | |

APPROVALS



PRODUCT CONFIGURATION

PRODUCT IDENTIFIER **1**

G = G Series Precision Turbine Meter

FITTING TYPE **2**

SC = Sanitary Clamp

SHAFT / SLEEVE BEARING / THRUST BEARING **3**

P = Stainless Steel / PTFE / 440C Stainless Steel

TURBINE SIZE & FLOWRATE **4**

-05175 = 1/2 in. Turbine, 3/4 in. Fitting, Low Flow

-05110 = 1/2 in. Turbine, 1 in. Fitting, Low Flow

-07515 = 3/4 in. Turbine, 1-1/2 in. Fitting, Standard

-075E15 = 3/4 in. Turbine, 1-1/2 in. Fitting, Ext-Range

-10015 = 1 in. Turbine, 1-1/2 in. Fitting, Standard

-15015 = 1-1/2 in. Turbine, 1-1/2 in. Fitting, Standard

-20020 = 2 in. Turbine, 2 in. Fitting, Standard

SENSOR CHOICE **5**

1 = Low Drag Standard Sensor with 12 inch Lead Wires

2 = Standard Sensor with 12 inch Lead Wires

X = No Sensor - Turbine Body Only

ELECTRONIC CHOICE (LOCAL) **6**

Turbine Mounted

-5 = GG510 - Standard Display

-6 = GX510 - 4-20 mA Transmitter with Display

-7 = GA510 - 4-20 mA Transmitter

-8 = SC510 - Scaled Pulse Output

-X = No Electronics - Turbine Body Only

1 2 3 4 5 6
 ---->>>> **G + SC + P + -05175 + 2 + -6 = SAMPLE**

SPECIFICATIONS

Design Type:	Turbine		
Fitting Type:	Sanitary Clamp		
Housing Material:	316 Stainless Steel		
Meter Sizes Available:	1/2" 3/4" 1" 1-1/2" 2"		
Meter ID:	1/2" --> 3/4" Fitting		
	1/2" --> 1" Fitting		
	3/4" --> 1-1/2" Fitting		
	1" --> 1-1/2" Fitting		
	1-1/2" --> 1-1/2" Fitting		
	2" --> 2" Fitting		
Flow Range:	1/2" (050)◆	0.6 - 6 GPM	(2.2 - 22 LPM)
	1/2" (051)	0.8 - 6 GPM	(3.0 - 22 LPM)
	3/4" (075)	1.6 - 16 GPM	(6.0 - 60 LPM)
	3/4" (075E)	2.3 - 23 GPM	(8.7 - 87 LPM)
	1" (100)	6.7 - 67 GPM	(25.2 - 252 LPM)
	1-1/2" (150)	17.7 - 177 GPM	(67 - 670 LPM)
	2" (200)	33 - 330 GPM	(125 - 1250 LPM)
Accuracy (Linearity):	± 0.5%		
Repeatability:	± 0.1%		
Pressure Rating:	Limited by fitting size, clamp size and temperature.		
Operating Temperature Range:	-100° F to +225° F (-74° C to +107° C)		
Typical K-Factor:	1/2" (050)	10,000 PPG / 2642 PPL	
	1/2" (051)	10,000 PPG / 2642 PPL	
	3/4" (075)	3,750 PPG / 991 PPL	
	3/4" (075E)	2,608 PPG / 689 PPL	
	1" (100)	896 PPG / 237 PPL	
	1-1/2" (150)	340 PPG / 90 PPL	
	2" (200)	181 PPG / 48 PPL	

◆GSCP-050 requires RF Pickup

ACCESSORIES / ELECTRONICS

Part No.	Description
80001100	X-Proof Enclosure
80001101	Weather proof enclosure - Zinc
80001102	X-Proof enclosure with Terminal Strip
80001105	Weather proof Enclosure - SS
GA500	4-20 mA Transmitter - Remote
GA510	4-20 mA Transmitter - Local
GG500-M	Display with pulse out - Remote
GG510-M	Display with pulse out - Local
GX500-M	Display with 4-20 mA Transmitter - Remote

Wetted Materials:	Housing:	316 Stainless Steel
	Sleeve Bearings:	PFTE
	Thrust Bearings:	440C Stainless Steel
	Shaft:	316 Stainless Steel
	Rotor:	CD4MCu Stainless Steel
	Rotor Supports:	316 Stainless Steel
	Retaining Rings:	300 Series Stainless Steel
Recommended Strainer Size:		
	1/2"	40 mesh
	3/4"	40 mesh
	1 inch	40 mesh
	1-1/2 inch	18 mesh
	2 inch	14 mesh
Frequency Output:	1/2" (050)	100 - 1000 Hz
	1/2" (051)	125 - 1000 Hz
	3/4" (075)	100 - 1000 Hz
	3/4" (075E)	100 - 1000 Hz
	1" (100)	100 - 1000 Hz
	1-1/2" (150)	100 - 1000 Hz
	2" (200)	100 - 1000 Hz
Calibration Report:	Comes standard with G Series meters.	
	N.I.S.T. - Certification available.	

DIMENSIONS

Meter Size	Length " (mm)	Height " (mm)
1/2"	2.75 (70)	1.63 (41)
3/4"	3.25 (82)	1.84 (47)
1"	3.56 (90)	1.84 (47)
1-1/2"	4.59 (116)	2.11 (53)
2"	6.06 (154)	2.39 (61)

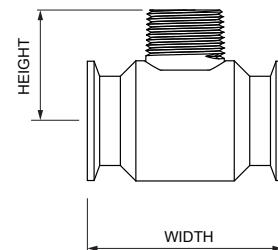

Part No.	Description
GX510-M	Display with 4-20 mA Transmitter - Local
SC500	Scaled Pulse Unit - Remote
SC510	Scaled Pulse Unit - Local
E112	Explosion-proof Display - Local
F Series (F116/F118/F126/F130)	Remote Panel Mount Electronics
N410	Deluxe Batch Controller

Service & Warranty: For technical assistance, warranty replacement or repair contact your **FLOMEC®** or **GPI®** distributor: In North or South America: **888-996-3837 / GPI.net**
Outside North or South America: **+61 2 9540 4433 / flomec.com.au**

Wichita · Sydney · Mexico City

GREAT PLAINS INDUSTRIES **GPI**